



Woodcote Park  
Banqueting Information

## Woodcote Park Tariff

---

Room	Daily Rate 8.30am to 5.30pm	Session Rate Morning, Lunch Afternoon or Evening from 6.30pm	Maximum Capacity		
			Theatre	Lunch/Dinner	Cocktail
Oaks	£220.00	£180.00	35	32	30
Library	£350.00	£200.00	N/A	16	30
Derby	£375.00	£250.00	70	60	80
Cedar	£1550.00	£1150.00	200	200	300

The hire of banqueting rooms without catering will incur a charge three times the quoted rate.

The above daily rates apply for guest wedding receptions at Woodcote Park.

For member wedding receptions, please see the daily rates listed below:

Room	Daily Rate
Oaks	£190.00
Library	£295.00
Derby	£320.00
Cedar	£1350.00

## **Optional Extras**

- Audio visual aids
- Musical entertainment
- Special menus
- Photography
- Outdoor pursuits
- Special occasion cakes
- Bespoke theming
- Use of Cedars Sports, Fitness and Health
- Golf lessons/clinics

**For more information telephone: 01372 229257  
or email: [banquetingwp@royalautomobileclub.co.uk](mailto:banquetingwp@royalautomobileclub.co.uk)**

# Woodcote Park Floor Plans

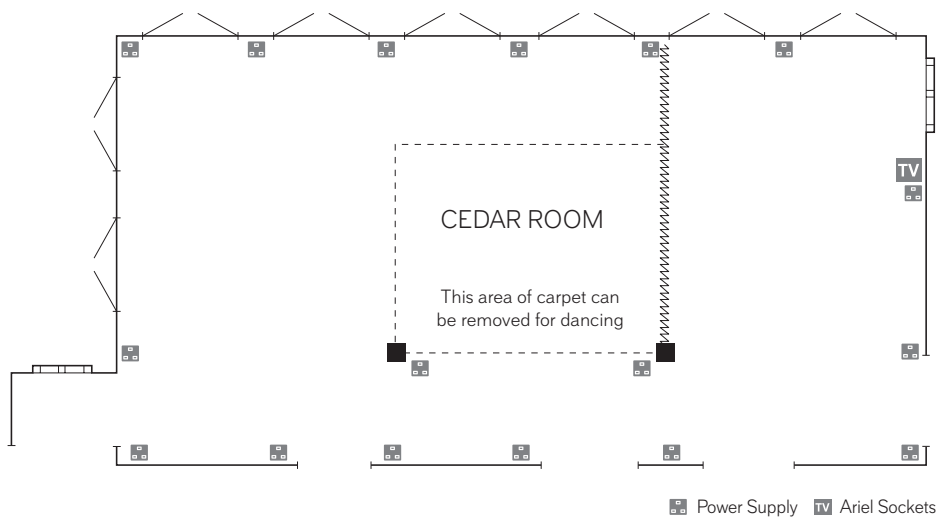

## Cedar Room

Natural daylight	Y
Chandeliers	Y
Which floor	G
Air conditioning	N
Length	76ft / 23m
Width	40ft / 12m
Height to chandelier	10ft / 3m
Ceiling height	12ft / 3.5m
Floor area	3040ft <sup>2</sup> / 276m <sup>2</sup>

Theatre style	200
Cabaret	100
Dinner rounds	200
Cocktail	300
Dinner dance	180

The Cedar Room is available to hire for a minimum of 100 people.

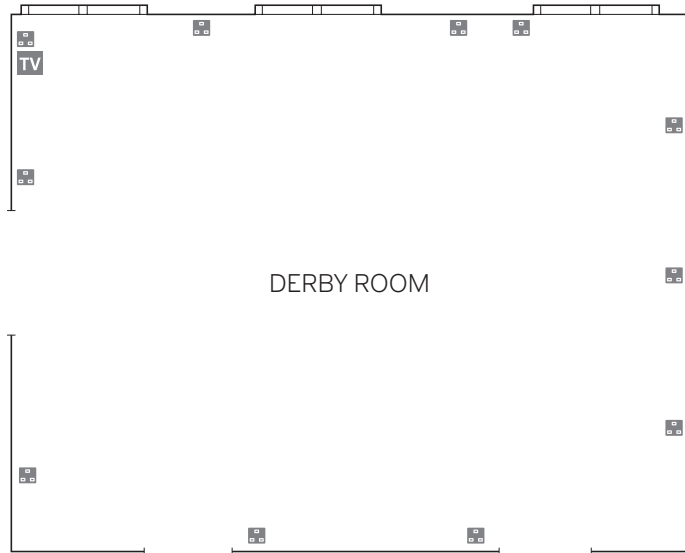

## Derby Room

Natural daylight	Y
Chandeliers	N
Which floor	1
Air conditioning	N
Length	36ft / 11m
Width	26ft / 8m
Height to chandelier	-
Ceiling height	12ft / 3.5m
Floor area	936ft <sup>2</sup> / 88m <sup>2</sup>

Open square	40
Theatre style	70
Boardroom/Dinner oval	30
U shape	56
Cabaret	48
Dinner rounds	60
Cocktail	80
Herringbone	72

# Woodcote Park Floor Plans

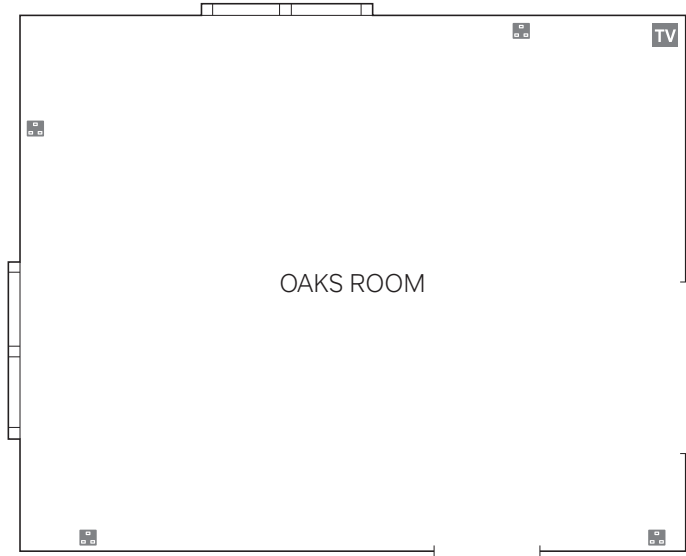

## Oaks Room

Natural daylight	Y
Chandeliers	Y
Which floor	1
Air conditioning	N
Length	22ft / 7m
Width	20ft / 6m
Height to chandelier	-
Ceiling height	12ft / 3.5m
Floor area	420ft <sup>2</sup> / 42m <sup>2</sup>

Theatre style	35
Boardroom/Dinner oval	16
U shape	25
Star plan	32
Cocktail	30
Dinner rounds	24

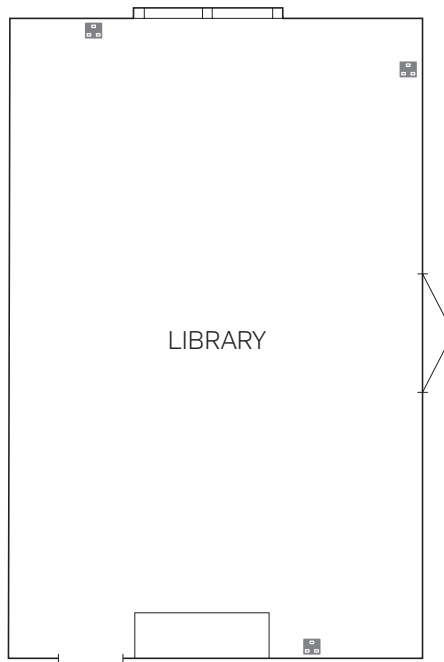

## Library

Natural daylight	Y
Chandeliers	Y
Which floor	1
Air conditioning	N

Boardroom/Dinner oval	16
Cocktail	30
Dinner rounds	26

Length	25ft / 7.5m
Width	19ft / 6m
Height to chandelier	8ft / 2.5m
Ceiling height	12ft / 3.5m
Floor area	490ft <sup>2</sup> / 45m <sup>2</sup>

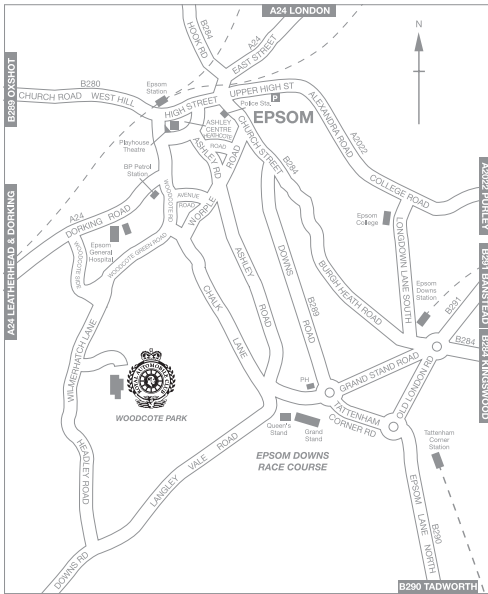

Woodcote Park  
 Epsom  
 Surrey KT18 7EW  
 Telephone 01372 229266  
[www.royalautomobileclub.co.uk](http://www.royalautomobileclub.co.uk)

## By Public Transport

### National Rail

Epsom. Trains every 30 minutes from both London Waterloo and Victoria.

### By Car From the M25

Leave the M25 at junction 9 and follow signs for A243 (A24) to Epsom. Take the A24 to Epsom and follow this road through Ashted Village. Turn right off the A24 (signposted Epsom Downs) into Woodcote Side. When the road bends take the immediate right and then turn right into Wilmerhatch Lane. Follow this road and you will find the clubhouse gates on your left.

### By Car From Epsom

Follow the A24 towards Dorking from Epsom town centre. When you reach the traffic lights opposite a BP petrol station, turn left into Woodcote Road. Follow the road through to Wilmerhatch Lane. The clubhouse gates are on your left.

This information was correct at the time of going to print. For up-to-date information please visit our website [www.royalautomobileclub.co.uk](http://www.royalautomobileclub.co.uk)